

# 20' BEERCAN

Mobile or Permanent Taproom



Starting At (Base Model) = \$58,000

## Base Model:



## Base Model + Optional Upgrades:

Specific upgrades shown in the renderings below are for visualization purposes only. Customers can choose from the full list of optional upgrades on the next page to customize their BeerCan to fit their specific needs & match their brand (at an additional cost to the base model price).



## Floor Plan:

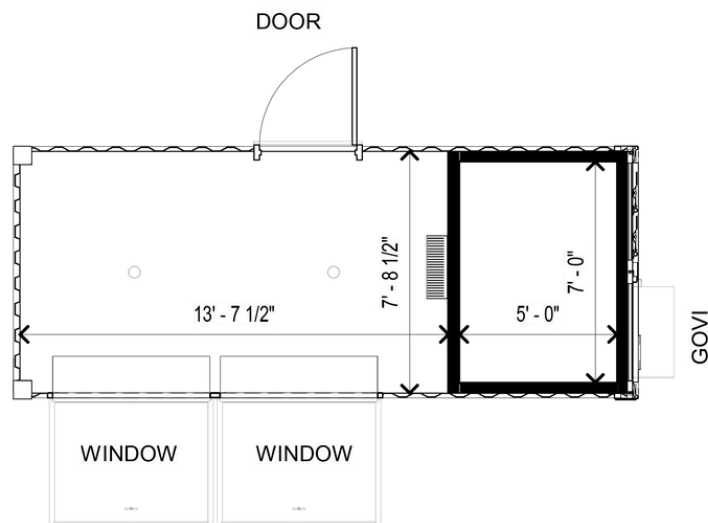

# 20' BEERCAN

Mobile or Permanent Taproom



Starting At (Base Model) = \$58,000

## BASE MODEL INCLUDES

All of the specs & features found below are included in the 20' BeerCan base model price of \$58,000.

### Container Type:

- 20' Standard new/one-trip shipping container

### Interior:

- Interior Serving Area: Standard painted exposed shipping container walls/ceiling, LVT finish on draft wall, painted floor (gray)
- 8' x 5' Walk-In Cooler with white PVC walls/ceiling & diamond plate flooring
- 6-tap standard draft tower with through-wall connections to cooler
- (2) Interior stainless steel fixed countertops (14" x 60" each)
- Standard paint color - must be the same color as exterior (Paint color options shown below)

### Exterior:

- Standard paint color - must be the same color as interior (Paint color options shown below)

### Openings:

- 36" x 80" Standard painted hollow metal door with locking levers, wind chain, door sweep, threshold, and drip edge
- (2) Awnings: 5' wide x 4' tall with gas struts and locking pins

### Mechanical:

- GOVI refrigeration unit

### Electrical:

- 100 amp electrical panel
- (3) GFCI duplex outlets in the bar area, (1) GFCI for Govi unit, (2) standard interior duplex outlets, (1) duplex cooler outlet, (2) light switches (1 bar area, 1 cooler)
- (2) Cage lights (bar area) and (1) 48" vapor tight light (cooler)

### Exterior & Interior Paint Color Options:

\*Base model exterior & interior paint must be the same color



## OPTIONAL UPGRADES

All optional upgrades below come at an additional cost to the base model price.

### Interior Upgrades:

- Bar equipment
- Upgraded countertops
- Custom painted floor color
- LVT floor
- Standard epoxy floor finish (white w/grey flecks or custom color)
- Additional taps
- Bar shelves on the back wall
- Diamond plate wainscotting
- Custom paint color
- Custom vinyl artwork

### Exterior Upgrades:

- Custom paint color
- Custom vinyl artwork
- Exterior Countertops (Folding countertops)
- Roof deck & stairs
- Menu boards
- Signage on walls or roof
- Cladding

### Openings Upgrades:

- Additional entry door
- Additional window/awnings (up to 2 more)
- Window/Awning size increase (Can increase to 6' awnings with a 5' cooler)

### Mechanical Upgrades:

- Through wall AC/Heater
- (2) 14" upper-wall-mounted fans with 2 dedicated outlets

### Electrical Upgrades:

- Additional switches
- Additional outlets
- Additional lights
- Track lighting
- Rooftop power/exterior power
- External power connection

### Plumbing Upgrades:

- Plumbing fixtures (sinks)
- Hose bibs
- Floor drains
- Plumbing equipment (dishwasher, warewashers, etc.)

### Other Upgrades:

- Cameras
- Speakers
- Low voltage equipment